

Schindler 7000

Planning parameters of
high-rise elevators.



Schindler



The journey to the top. From outline to skyline.

You and Schindler share the same objective:
a well-elevated building, which ensures that
people reach their destinations swiftly, comfortably
and above all safely.

We are passionate about providing you with the
very best achievable elevator system using our
world class design skills and products.

You want to end up with a top Class project.
That "Journey to the top" starts with Schindler's
innovation, reliability and product leadership.

Planning parameters.

Load		Speed	Travel height max.	Car	Door	Hoistway	Machine room	Overhead clearance	Pit depth					
kg	Persons	m/s	m	BK x TK mm	BT x HT mm	BS x TS mm	BO x TO x HO mm	HSK mm	HSG mm					
900	12	2.5	125											
				1500 x 1400						900 x 2100	2100 x 2200	2200 x 4400 x 2300	HK+2400	2100
				1550 x 1350							2100 x 2150	2200 x 4350 x 2300		
				1600 x 1300							2150 x 2100	2200 x 4300 x 2300		
				1600 x 1300						1000 x 2100	2300 x 2100	2300 x 4300 x 2300		
				1600 x 1350							2300 x 2150	2300 x 4350 x 2300		
1600 x 1400		2300 x 2200	2300 x 4400 x 2300											
900	12	2.5	150											
				1500 x 1400						900 x 2100	2100 x 2200	2200 x 4400 x 2300	HK+2400	2800
				1550 x 1350							2150 x 2150	2200 x 4350 x 2300		
				1600 x 1300							2200 x 2100	2250 x 4300 x 2300		
				1600 x 1300						1000 x 2100	2300 x 2100	2300 x 4300 x 2300		
				1600 x 1350							2300 x 2150	2300 x 4350 x 2300		
1600 x 1400		2300 x 2200	2300 x 4400 x 2300											
900	12	3	180											
				1500 x 1400						900 x 2100	2100 x 2200	2200 x 4400 x 2300	HK+2400	2800
				1550 x 1350							2150 x 2150	2200 x 4350 x 2300		
				1600 x 1300							2200 x 2100	2250 x 4300 x 2300		
				1600 x 1300						1000 x 2100	2300 x 2100	2300 x 4300 x 2300		
				1600 x 1350							2300 x 2150	2300 x 4350 x 2300		
1600 x 1400		2300 x 2200	2300 x 4400 x 2300											
900	12	3.5	210											
				1500 x 1400						900 x 2100	2100 x 2250	2200 x 4450 x 2500	HK+2400	2900
				1550 x 1350							2150 x 2200	2200 x 4400 x 2500		
				1600 x 1300							2200 x 2150	2250 x 4350 x 2500		
				1600 x 1300						1000 x 2100	2300 x 2150	2300 x 4350 x 2500		
				1600 x 1350							2300 x 2200	2300 x 4400 x 2500		
1600 x 1400		2300 x 2250	2300 x 4450 x 2500											
900	12	4	240											
				1500 x 1400						900 x 2100	2100 x 2250	2200 x 4450 x 2500	HK+2700	3600
				1550 x 1350							2150 x 2200	2200 x 4400 x 2500		
				1600 x 1300							2200 x 2150	2250 x 4350 x 2500		
				1600 x 1300						1000 x 2100	2300 x 2150	2300 x 4350 x 2500		
				1600 x 1350							2300 x 2200	2300 x 4400 x 2500		
1600 x 1400		2300 x 2250	2300 x 4450 x 2500											
900	12	5	240											
				1500 x 1400						900 x 2100	2100 x 2250	2100 x 4450 x 3700	HK+2800	3600
				1550 x 1350							2150 x 2200	2150 x 4400 x 3700		
				1600 x 1300							2200 x 2150	2200 x 4350 x 3700		
				1600 x 1300						1000 x 2100	2300 x 2150	2300 x 4350 x 3700		
				1600 x 1350							2300 x 2200	2300 x 4400 x 3700		
1600 x 1400		2300 x 2250	2300 x 4450 x 3700											
900	12	6	240											
				1500 x 1400						900 x 2100	2100 x 2250	2100 x 4450 x 3700	HK+3100	3700
				1550 x 1350							2150 x 2200	2150 x 4400 x 3700		
				1600 x 1300							2200 x 2150	2200 x 4350 x 3700		
				1600 x 1300						1000 x 2100	2300 x 2150	2300 x 4350 x 3700		
				1600 x 1350							2300 x 2200	2300 x 4400 x 3700		
1600 x 1400		2300 x 2250	2300 x 4450 x 3700											

Reaction load				Motor	Power supply capacity (380 V – 415 V)								Starting power	Heat dissipation in machine room	
R1 kg	R2 kg	R3 kg	R4 kg	PME KW	1 Unit kVA	2 Unit kVA	3 Unit kVA	4 Unit kVA	5 Unit kVA	6 Unit kVA	7 Unit kVA	8 Unit kVA	kVA	KW	Kcal/h
8800	5600	9000	5800	13.2	22.9	41.7	61.9	80.7	96.3	110.1	123.6	137.6	48	1.98	1683
8800	5600	9000	5800												
8800	5700	9000	5800												
8800	5700	9000	5800												
8900	5700	9100	5800												
8900	5700	9100	5900												
10100	6400	13400	5900	15.1	25.7	46.8	69.4	90.5	108.0	123.4	138.5	154.2	54	2.27	1925
10100	6400	13400	5900												
10000	6500	13400	5900												
10100	6500	13400	5900												
10100	6500	13400	5900												
10200	6400	13500	6000												
10300	6400	15100	5900	18.5	29.8	54.2	80.4	104.9	125.1	143.0	160.6	178.7	66	2.78	2359
10300	6400	15100	5900												
10200	6500	15100	6000												
10200	6500	15100	6000												
10300	6500	15100	6000												
10400	6500	15200	6000												
11100	7100	17000	6100	21.1	32.4	59.0	87.5	114.1	136.2	155.6	174.8	194.5	71	3.17	2691
11100	7200	17000	6100												
11700	7600	17300	6200												
11000	7200	17000	6200												
11800	7600	17300	6200												
11700	7500	17300	6200												
12000	7600	19100	6200	24.0	35.9	65.3	96.9	126.3	150.7	172.3	193.4	215.3	86	3.60	3060
11900	7700	19100	6200												
11900	7700	19100	6200												
11900	7700	19100	6200												
12000	7700	19100	6200												
12100	7700	19200	6300												
24100	15400	19100	6200	32.3	48.1	87.5	129.8	169.2	201.9	230.8	259.2	288.5	106	2.26	1922
24100	15400	19100	6200												
24000	15500	19100	6200												
24000	15500	19100	6200												
24200	15500	19100	6200												
24400	15500	19200	6300												
24100	15400	19100	6200	38.8	55.9	101.8	151.0	196.8	234.8	268.4	301.3	335.5	124	2.72	2309
24100	15400	19100	6200												
24000	15500	19100	6200												
24000	15600	19100	6200												
24200	15500	19100	6200												
24300	15500	19200	6300												

Planning parameters.

Load		Speed	Travel height max.	Car	Door	Hoistway	Machine room	Overhead clearance	Pit depth
kg	Persons	m/s	m	BK x TK mm	BT x HT mm	BS x TS mm	BO x TO x HO mm	HSK mm	HSG mm
1000	13	2.5	125						
				1600 x 1400	900 x 2100	2200 x 2200	2250 x 4400 x 2300	HK+2400	2100
				1600 x 1500		2200 x 2300	2250 x 4500 x 2300		
				1600 x 1400	1000 x 2100	2300 x 2200	2300 x 4400 x 2300		
				1600 x 1500		2300 x 2300	2300 x 4500 x 2300		
				1600 x 1400	1100 x 2100	2500 x 2200	2500 x 4400 x 2300		
1000	13	2.5	150	1600 x 1400	900 x 2100	2200 x 2200	2250 x 4400 x 2500	HK+2500	2800
				1600 x 1500		2200 x 2300	2250 x 4500 x 2500		
				1600 x 1400	1000 x 2100	2300 x 2200	2300 x 4400 x 2500		
				1600 x 1500		2300 x 2300	2300 x 4500 x 2500		
				1600 x 1400	1100 x 2100	2500 x 2200	2500 x 4400 x 2500		
				1600 x 1500		2500 x 2300	2500 x 4500 x 2500		
1000	13	3	180	1600 x 1400	900 x 2100	2200 x 2200	2250 x 4400 x 2500	HK+2400	2900
				1600 x 1500		2200 x 2300	2250 x 4500 x 2500		
				1600 x 1400	1000 x 2100	2300 x 2200	2300 x 4400 x 2500		
				1600 x 1500		2300 x 2300	2300 x 4500 x 2500		
				1600 x 1400	1100 x 2100	2500 x 2200	2500 x 4400 x 2500		
				1600 x 1500		2500 x 2300	2500 x 4500 x 2500		
1000	13	3.5	210	1600 x 1400	900 x 2100	2200 x 2250	2250 x 4450 x 2500	HK+2700	2900
				1600 x 1500		2200 x 2350	2250 x 4550 x 2500		
				1600 x 1400	1000 x 2100	2300 x 2250	2300 x 4450 x 2500		
				1600 x 1500		2300 x 2350	2300 x 4550 x 2500		
				1600 x 1400	1100 x 2100	2500 x 2250	2500 x 4450 x 2500		
				1600 x 1500		2500 x 2350	2500 x 4550 x 2500		
1000	13	4	240	1600 x 1400	900 x 2100	2200 x 2250	2250 x 4450 x 2500	HK+2800	3600
				1600 x 1500		2200 x 2350	2250 x 4550 x 2500		3500
				1600 x 1400	1000 x 2100	2300 x 2250	2300 x 4450 x 2500		3600
				1600 x 1500		2300 x 2350	2300 x 4550 x 2500		3500
				1600 x 1400	1100 x 2100	2500 x 2250	2500 x 4450 x 2500		3600
				1600 x 1500		2500 x 2350	2500 x 4550 x 2500		3500
1000	13	5	240	1600 x 1400	900 x 2100	2200 x 2250	2200 x 4450 x 3700	HK+2800	3600
				1600 x 1500		2200 x 2350	2200 x 4550 x 3700		3500
				1600 x 1400	1000 x 2100	2300 x 2250	2300 x 4450 x 3700		3600
				1600 x 1500		2300 x 2350	2300 x 4550 x 3700		3500
				1600 x 1400	1100 x 2100	2500 x 2250	2500 x 4450 x 3700		3600
				1600 x 1500		2500 x 2350	2500 x 4550 x 3700		3500
1000	13	5	240	1600 x 1400	900 x 2100	2200 x 2250	2200 x 4450 x 3700	HK+2800	3600
				1600 x 1500		2200 x 2350	2200 x 4550 x 3700		3500
				1600 x 1400	1000 x 2100	2300 x 2250	2300 x 4450 x 3700		3600
				1600 x 1500		2300 x 2350	2300 x 4550 x 3700		3500
				1600 x 1400	1100 x 2100	2500 x 2250	2500 x 4450 x 3700		3600
				1600 x 1500		2500 x 2350	2500 x 4550 x 3700		3500

Reaction load				Motor	Power supply capacity (380 V – 415 V)								Starting power	Heat dissipation in machine room	
R1 kg	R2 kg	R3 kg	R4 kg	PME KW	1 Unit kVA	2 Unit kVA	3 Unit kVA	4 Unit kVA	5 Unit kVA	6 Unit kVA	7 Unit kVA	8 Unit kVA	kVA	KW	Kcal/h
9500	6100	11700	6200	14.7	25.0	45.5	67.5	88.0	105.0	120.0	134.8	150.1	54	2.21	1874
9700	6100	11700	6200												
9500	6100	11700	6200												
9700	6100	11700	6200												
9600	6100	11700	6200												
9700	6100	11700	6300												
9800	6100	11700	6300												
10700	6900	13500	6200	16.5	26.9	48.9	72.6	94.6	112.9	129.0	144.9	161.3	52	2.48	2104
10900	6900	13500	6300												
10700	6900	13500	6300												
10900	6900	13500	6300												
10800	6900	13500	6300												
11000	6900	13500	6400												
11000	6900	13600	6400												
11900	7500	15600	6500	19.2	30.1	54.8	81.4	106.1	126.6	144.7	162.4	180.8	65	2.88	2448
12000	7500	15700	6600												
11900	7600	15600	6500												
12000	7500	15700	6600												
11900	7600	15600	6500												
12100	7600	15700	6600												
12200	7600	15700	6700												
12000	7800	17500	6500	22.8	34.5	62.8	93.2	121.4	144.9	165.6	186.0	207.0	78	3.42	2907
12200	7700	17500	6600												
12000	7800	17500	6500												
12200	7800	17500	6600												
12100	7800	17500	6600												
12300	7800	17600	6600												
12300	7800	17600	6700												
12400	8000	19300	6600	26.3	38.9	70.7	104.9	136.8	163.2	186.6	209.5	233.2	91	3.95	3354
12600	8000	19400	6600												
12400	8000	19400	6600												
12600	8000	19400	6600												
12400	8000	19400	6600												
12600	8000	19400	6700												
12700	8000	19400	6700												
25000	16100	19300	6600	35.2	51.9	94.4	140.1	182.7	217.9	249.1	279.7	311.3	113	2.46	2095
25400	16000	19400	6600												
25000	16100	19400	6600												
25400	16100	19400	6600												
25100	16100	19400	6600												
25500	16100	19400	6700												
25600	16100	19400	6700												

Planning parameters.

Load		Speed	Travel height max.	Car	Door	Hoistway	Machine room	Overhead clearance	Pit depth			
kg	Persons	m/s	m	BK x TK mm	BT x HT mm	BS x TS mm	BO x TO x HO mm	HSK mm	HSG mm			
1000	13	6	240									
				1600 x 1400	900 x 2100	2200 x 2250	2200 x 4450 x 3700	HK+3100	3700			
				1600 x 1500		2200 x 2350	2200 x 4550 x 3700					
				1600 x 1400	1000 x 2100	2300 x 2250	2300 x 4450 x 3700					
				1600 x 1500		2300 x 2350	2300 x 4550 x 3700					
				1600 x 1400	1100 x 2100	2500 x 2250	2500 x 4450 x 3700					
1150	15	2.5	125	1600 x 1500		2500 x 2350	2500 x 4550 x 3700					
				1600 x 1550		2500 x 2400	2500 x 4600 x 3700					
				1950 x 1300	1000 x 2100	2550 x 2100	2550 x 4300 x 2500	HK+2400	2100			
				1950 x 1400		2550 x 2200	2550 x 4400 x 2500					
1150	15	2.5	150	1950 x 1300	1100 x 2100	2550 x 2100	2550 x 4300 x 2500					
				1950 x 1400		2550 x 2200	2550 x 4400 x 2500					
1150	15	3	180	1950 x 1300	1000 x 2100	2550 x 2100	2550 x 4300 x 2500	HK+2400	2900			
				1950 x 1400		2550 x 2200	2550 x 4400 x 2500					
				1950 x 1300	1100 x 2100	2550 x 2100	2550 x 4300 x 2500					
				1950 x 1400		2550 x 2200	2550 x 4400 x 2500					
1150	15	3.5	210	1950 x 1300	1000 x 2100	2550 x 2150	2550 x 4350 x 2500	HK+2400	2900			
				1950 x 1400		2550 x 2250	2550 x 4450 x 2500					
				1950 x 1300	1100 x 2100	2550 x 2150	2550 x 4350 x 2500					
				1950 x 1400		2550 x 2250	2550 x 4450 x 2500					
1150	15	4	240	1950 x 1300	1000 x 2100	2550 x 2150	2550 x 4350 x 2500	HK+2700	3600			
				1950 x 1400		2550 x 2250	2550 x 4450 x 2500					
				1950 x 1300	1100 x 2100	2550 x 2150	2550 x 4350 x 2500					
				1950 x 1400		2550 x 2250	2550 x 4450 x 2500					
1150	15	5	240	1950 x 1300	1000 x 2100	2550 x 2150	2550 x 4350 x 3700	HK+2800	3600			
				1950 x 1400		2550 x 2250	2550 x 4450 x 3700					
				1950 x 1300	1100 x 2100	2550 x 2150	2550 x 4350 x 3700					
				1950 x 1400		2550 x 2250	2550 x 4450 x 3700					
1150	15	6	240	1950 x 1300	1000 x 2100	2550 x 2150	2550 x 4350 x 3700	HK+3100	3700			
				1950 x 1400		2550 x 2250	2550 x 4450 x 3700					
				1950 x 1300	1100 x 2100	2550 x 2150	2550 x 4350 x 3700					
				1950 x 1400		2550 x 2250	2550 x 4450 x 3700					
1275	17	2.5	125	2000 x 1400	900 x 2100	2600 x 2200	2600 x 4400 x 2500	HK+2400	2100			
		2.5	150						2800			
		3	180						2900			
		3.5	210									
		4	240						2600 x 2250	2600 x 4450 x 2500	HK+2700	3600
		5							2600 x 4450 x 3700	HK+2800		
6		2600 x 4450 x 3700	HK+3100	3700								

Reaction load				Motor	Power supply capacity (380 V – 415 V)								Starting power	Heat dissipation in machine room	
R1 kg	R2 kg	R3 kg	R4 kg	PME KW	1 Unit kVA	2 Unit kVA	3 Unit kVA	4 Unit kVA	5 Unit kVA	6 Unit kVA	7 Unit kVA	8 Unit kVA	kVA	KW	Kcal/h
25000	16100	19300	6600	42.2	60.3	109.8	162.9	212.4	253.4	289.6	325.2	362.1	134	2.95	2511
25400	16100	19400	6600												
25000	16100	19400	6600												
25400	16100	19400	6600												
25100	16100	19400	6600												
25400	16100	19400	6700												
25600	16100	19400	6700												
10400	6900	12000	6700	16.9	27.3	49.7	73.7	96.1	114.6	131.0	147.1	163.8	53	2.54	2155
10600	6900	12000	6700												
10400	6900	12000	6700												
10600	6900	12000	6700												
11800	7800	14100	6900	18.5	29.5	53.7	79.7	103.9	124.0	141.7	159.1	177.1	59	2.78	2359
12000	7700	14100	7000												
11900	7800	14100	6900												
12000	7700	14100	7000												
12400	8100	16000	7000	21.9	33.7	61.4	91.1	118.8	141.7	161.9	181.9	202.4	72	3.29	2793
12500	8100	16000	7100												
12400	8100	16000	7000												
12600	8100	16000	7100												
12700	8400	17800	7000												
12900	8400	17900	7100												
12800	8400	17800	7100												
12900	8400	17900	7100												
12900	8500	19700	7100	29.9	43.4	79.1	117.3	152.9	182.4	208.5	234.1	260.6	99	4.49	3813
13100	8500	19700	7100												
12900	8500	19700	7100												
13100	8500	19700	7200												
26000	17100	19700	7000	39.6	57.6	104.9	155.6	202.9	242.1	276.7	310.7	345.8	123	2.77	2356
26300	17000	19700	7100												
26000	17100	19700	7100												
26400	17100	19700	7100												
26000	17100	19700	7000	47.5	67.1	122.1	181.1	236.1	281.7	321.9	361.5	402.4	145	3.33	2827
26300	17000	19700	7100												
26000	17100	19700	7100												
26400	17100	19700	7100												
11300	7400	12300	7100	18.7	29.7	54.1	80.2	104.6	124.8	142.7	160.2	178.3	58	2.81	2385
12500	8100	14300	7300	20.4	32.0	58.3	86.4	112.7	134.4	153.6	172.5	192.0	63	3.06	2601
13000	8400	16200	7400	24.1	36.7	66.8	99.1	129.2	154.2	176.2	197.9	220.3	76	3.62	3073
14000	9100	18300	7500	28.0	41.3	75.1	111.5	145.3	173.4	198.2	222.6	247.7	93	4.20	3570
14100	9200	20200	7500	32.3	44.8	81.6	121.0	157.8	188.3	215.2	241.6	268.9	105	2.26	1922
27200	17700	19900	7500	43.2	62.5	113.7	168.7	220.0	262.5	300.0	336.8	374.9	133	3.02	2571
27200	17700	19900	7500	51.9	73.0	132.8	197.0	256.8	306.4	350.2	393.2	437.7	155	3.63	3088

Planning parameters.

Load		Speed	Travel height max.	Car	Door	Hoistway	Machine room	Overhead clearance	Pit depth		
kg	Persons	m/s	m	BK x TK mm	BT x HT mm	BS x TS mm	BO x TO x HO mm	HSK mm	HSG mm		
1350	18	2.5	125	1950 x 1500	1100 x 2100	2550 x 2300	2550 x 4500 x 2500	HK+2400	2300		
				2000 x 1550		2600 x 2350	2600 x 4550 x 2500				
				1950 x 1500	1200 x 2100	2700 x 2300	2700 x 4500 x 2500				
				2000 x 1550		2700 x 2350	2700 x 4550 x 2500				
				1950 x 1500	1100 x 2100	2550 x 2300	2550 x 4500 x 2500				
				2000 x 1550		2600 x 2350	2600 x 4550 x 2500				
				1950 x 1500	1200 x 2100	2700 x 2300	2700 x 4500 x 2500				
				2000 x 1550		2700 x 2350	2700 x 4550 x 2500				
1350	18	2.5	150	1950 x 1500	1100 x 2100	2550 x 2300	2550 x 4500 x 2500	HK+2400	2800		
				2000 x 1550		2600 x 2350	2600 x 4550 x 2500				
				1950 x 1500	1200 x 2100	2700 x 2300	2700 x 4500 x 2500				
				2000 x 1550		2700 x 2350	2700 x 4550 x 2500				
				1950 x 1500	1100 x 2100	2550 x 2300	2550 x 4500 x 2500				
				2000 x 1550		2600 x 2350	2600 x 4550 x 2500				
				1950 x 1500	1200 x 2100	2700 x 2300	2700 x 4500 x 2500				
				2000 x 1550		2700 x 2350	2700 x 4550 x 2500				
1350	18	3	180	1950 x 1500	1100 x 2100	2550 x 2300	2550 x 4500 x 2500	HK+2400	2900		
				2000 x 1550		2600 x 2350	2600 x 4550 x 2500				
				1950 x 1500	1200 x 2100	2700 x 2300	2700 x 4500 x 2500				
				2000 x 1550		2700 x 2350	2700 x 4550 x 2500				
				1950 x 1500	1100 x 2100	2550 x 2350	2550 x 4550 x 2500				
				2000 x 1550		2600 x 2400	2600 x 4600 x 2500				
				1950 x 1500	1200 x 2100	2700 x 2350	2700 x 4550 x 2500				
				2000 x 1550		2700 x 2400	2700 x 4600 x 2500				
1350	18	3.5	210	1950 x 1500	1100 x 2100	2550 x 2350	2550 x 4550 x 2500	HK+2400	2900		
				2000 x 1550		2600 x 2400	2600 x 4600 x 2500				
				1950 x 1500	1200 x 2100	2700 x 2350	2700 x 4550 x 2500				
				2000 x 1550		2700 x 2400	2700 x 4600 x 2500				
				1950 x 1500	1100 x 2100	2550 x 2350	2550 x 4550 x 2500				
				2000 x 1550		2600 x 2400	2600 x 4600 x 2500				
				1950 x 1500	1200 x 2100	2700 x 2350	2700 x 4550 x 3700				
				2000 x 1550		2700 x 2400	2700 x 4600 x 3700				
1350	18	4	240	1950 x 1500	1100 x 2100	2550 x 2350	2550 x 4550 x 2500	HK+2700	3500		
				2000 x 1550		2600 x 2400	2600 x 4600 x 2500				
				1950 x 1500	1200 x 2100	2700 x 2350	2700 x 4550 x 2500				
				2000 x 1550		2700 x 2400	2700 x 4600 x 2500				
				1950 x 1500	1100 x 2100	2550 x 2350	2550 x 4550 x 3700				
				2000 x 1550		2600 x 2400	2600 x 4600 x 3700				
				1950 x 1500	1200 x 2100	2700 x 2350	2700 x 4550 x 3700				
				2000 x 1550		2700 x 2400	2700 x 4600 x 3700				
1350	18	5	240	1950 x 1500	1100 x 2100	2550 x 2350	2550 x 4550 x 3700	HK+2800	3500		
				2000 x 1550		2600 x 2400	2600 x 4600 x 3700				
				1950 x 1500	1200 x 2100	2700 x 2350	2700 x 4550 x 3700				
				2000 x 1550		2700 x 2400	2700 x 4600 x 3700				
				1950 x 1500	1100 x 2100	2550 x 2350	2550 x 4550 x 3700				
				2000 x 1550		2600 x 2400	2600 x 4600 x 3700				
				1950 x 1500	1200 x 2100	2700 x 2350	2700 x 4550 x 3700				
				2000 x 1550		2700 x 2400	2700 x 4600 x 3700				
1350	18	6	240	1950 x 1500	1100 x 2100	2550 x 2350	2550 x 4550 x 3700	HK+3100	3700		
				2000 x 1550		2600 x 2400	2600 x 4600 x 3700				
				1950 x 1500	1200 x 2100	2700 x 2350	2700 x 4550 x 3700				
				2000 x 1550		2700 x 2400	2700 x 4600 x 3700				
				2000 x 1700	1100 x 2100	2600 x 2500	2600 x 4700 x 2500			HK+2400	2300
				2050 x 1750		2650 x 2550	2650 x 4750 x 2500				
				2000 x 1700	1200 x 2100	2700 x 2500	2700 x 4700 x 2500				
				2050 x 1750		2700 x 2550	2700 x 4750 x 2500				
2000 x 1700	1100 x 2100	2600 x 2500	2600 x 4700 x 2500								
2050 x 1750		2650 x 2550	2650 x 4750 x 2500								
2000 x 1700	1200 x 2100	2700 x 2500	2700 x 4700 x 2500								
2050 x 1750		2700 x 2550	2700 x 4750 x 2500								
1600	21	2.5	125	2000 x 1700	1100 x 2100	2600 x 2500	2600 x 4700 x 2500	HK+2400	2300		
				2050 x 1750		2650 x 2550	2650 x 4750 x 2500				
				2000 x 1700	1200 x 2100	2700 x 2500	2700 x 4700 x 2500				
				2050 x 1750		2700 x 2550	2700 x 4750 x 2500				
				2000 x 1700	1100 x 2100	2600 x 2500	2600 x 4700 x 2500				
				2050 x 1750		2650 x 2550	2650 x 4750 x 2500				
				2000 x 1700	1200 x 2100	2700 x 2500	2700 x 4700 x 2500				
				2050 x 1750		2700 x 2550	2700 x 4750 x 2500				
1600	21	2.5	150	2000 x 1700	1100 x 2100	2600 x 2500	2600 x 4700 x 2500	HK+2400	2900		
				2050 x 1750		2650 x 2550	2650 x 4750 x 2500				
				2000 x 1700	1200 x 2100	2700 x 2500	2700 x 4700 x 2500				
				2050 x 1750		2700 x 2550	2700 x 4750 x 2500				
				2000 x 1700	1100 x 2100	2600 x 2500	2600 x 4700 x 2500				
				2050 x 1750		2650 x 2550	2650 x 4750 x 2500				
				2000 x 1700	1200 x 2100	2700 x 2500	2700 x 4700 x 2500				
				2050 x 1750		2700 x 2550	2700 x 4750 x 2500				
1600	21	3	180	2000 x 1700	1100 x 2100	2600 x 2500	2600 x 4700 x 2500	HK+2400	2900		
				2050 x 1750		2650 x 2550	2650 x 4750 x 2500				
				2000 x 1700	1200 x 2100	2700 x 2500	2700 x 4700 x 2500				
				2050 x 1750		2700 x 2550	2700 x 4750 x 2500				
				2000 x 1700	1100 x 2100	2600 x 2500	2600 x 4700 x 2500				
				2050 x 1750		2650 x 2550	2650 x 4750 x 2500				
				2000 x 1700	1200 x 2100	2700 x 2500	2700 x 4700 x 2500				
				2050 x 1750		2700 x 2550	2700 x 4750 x 2500				

Reaction load				Motor	Power supply capacity (380 V – 415 V)								Starting power	Heat dissipation in machine room	
R1 kg	R2 kg	R3 kg	R4 kg	PME KW	1 Unit kVA	2 Unit kVA	3 Unit kVA	4 Unit kVA	5 Unit kVA	6 Unit kVA	7 Unit kVA	8 Unit kVA	kVA	KW	Kcal/h
11700	7600	12400	7400	19.8	31.2	56.9	84.4	110.0	131.2	150.0	168.4	187.5	61	2.97	2525
11900	7600	12500	7500												
11800	7600	12400	7400												
11900	7600	12500	7500												
12700	8100	14400	7500	21.5	33.5	61.0	90.5	118.0	140.8	161.0	180.7	201.2	65	3.23	2742
12900	8200	14500	7600												
12800	8200	14400	7500												
12900	8200	14500	7600												
13300	8500	16300	7600	25.5	38.5	70.0	103.8	135.3	161.5	184.6	207.2	230.7	79	3.83	3252
13400	8500	16400	7700												
13300	8500	16400	7600												
13400	8500	16400	7700												
14000	9000	18400	7600	29.6	43.4	78.9	117.1	152.7	182.2	208.2	233.8	260.2	96	4.44	3774
14100	9000	18500	7700												
14000	9000	18400	7600												
14100	9000	18500	7700												
14400	9300	20300	7700	34.1	47.1	85.7	127.2	165.8	197.9	226.1	253.9	282.7	109	2.39	2029
14600	9300	20400	7700												
14400	9300	20300	7700												
14600	9300	20400	7800												
27800	17900	20000	7600	45.4	65.4	119.0	176.6	230.2	274.7	313.9	352.5	392.4	138	3.18	2702
28000	17900	20100	7700												
27800	17900	20100	7600												
28100	17900	20100	7700												
27800	17900	20000	7600	54.5	76.4	139.1	206.3	269.0	320.9	366.8	411.9	458.5	161	3.82	3243
28000	17900	20100	7700												
27800	17900	20100	7600												
28100	17900	20100	7700												
12800	8100	12900	8100	23.5	36.3	66.1	98.0	127.8	152.5	174.3	195.7	217.8	69	3.53	2997
12900	8100	13000	8200												
12800	8100	12900	8100												
12900	8100	13000	8200												
14300	8900	15100	8200	25.0	38.6	70.2	104.2	135.8	162.1	185.2	208.0	231.5	75	3.75	3188
14400	8900	15100	8300												
14300	8900	15100	8200												
14500	9000	15100	8300												
15300	9500	17200	8600	29.6	44.1	80.2	119.0	155.1	185.1	211.5	237.5	264.4	92	4.44	3774
15400	9500	17200	8700												
15300	9500	17200	8600												
15500	9500	17200	8700												

Planning parameters.

Load		Speed	Travel height max.	Car	Door	Hoistway	Machine room	Overhead clearance	Pit depth
kg	Persons	m/s	m	BK x TK mm	BT x HT mm	BS x TS mm	BO x TO x HO mm	HSK mm	HSG mm
1600	21	3.5	210						
				2000 x 1700	1100 x 2100	2600 x 2550	2600 x 4750 x 2500	HK+2400	2900
				2050 x 1750		2650 x 2600	2650 x 4800 x 2500		
				2000 x 1700	1200 x 2100	2700 x 2550	2700 x 4750 x 2500		
1600	21	4	240	2050 x 1750		2700 x 2600	2700 x 4800 x 2500		
				2000 x 1700	1100 x 2100	2600 x 2550	2600 x 4750 x 3700	HK+2700	3500
				2050 x 1750		2650 x 2600	2650 x 4800 x 3700		
				2000 x 1700	1200 x 2100	2700 x 2550	2700 x 4750 x 3700		
1600	21	5	240	2050 x 1750		2700 x 2600	2700 x 4800 x 3700		
				2000 x 1700	1100 x 2100	2600 x 2550	2600 x 4750 x 3700	HK+2800	3500
				2050 x 1750		2650 x 2600	2650 x 4800 x 3700		
				2000 x 1700	1200 x 2100	2700 x 2550	2700 x 4750 x 3700		
1600	21	6	240	2050 x 1750		2700 x 2600	2700 x 4800 x 3700		
				2000 x 1700	1100 x 2100	2600 x 2550	2600 x 4750 x 3700	HK+3100	3700
				2050 x 1750		2650 x 2600	2650 x 4800 x 3700		
				2000 x 1700	1200 x 2100	2700 x 2550	2700 x 4750 x 3700		
1800	24	2.5	125	2100 x 1750	1100 x 2100	2700 x 2550	2700 x 4750 x 2500	HK+2400	2300
				2150 x 1800		2750 x 2600	2750 x 4800 x 2500		
				2100 x 1750	1200 x 2100	2700 x 2550	2700 x 4750 x 2500		
				2150 x 1800		2750 x 2600	2750 x 4800 x 2500		
1800	24	2.5	150	2100 x 1750	1100 x 2100	2700 x 2550	2700 x 4750 x 2500	HK+2400	2800
				2150 x 1800		2750 x 2600	2750 x 4800 x 2500		
				2100 x 1750	1200 x 2100	2700 x 2550	2700 x 4750 x 2500		
				2150 x 1800		2750 x 2600	2750 x 4800 x 2500		
1800	24	3	180	2100 x 1750	1100 x 2100	2700 x 2550	2700 x 4750 x 3700	HK+2500	3000
				2150 x 1800		2750 x 2600	2750 x 4800 x 3700		
				2100 x 1750	1200 x 2100	2700 x 2550	2700 x 4750 x 3700		
				2150 x 1800		2750 x 2600	2750 x 4800 x 3700		
1800	24	3.5	210	2100 x 1750	1100 x 2100	2700 x 2600	2700 x 4800 x 3700	HK+2500	3000
				2150 x 1800		2750 x 2650	2750 x 4850 x 3700		
				2100 x 1750	1200 x 2100	2700 x 2600	2700 x 4800 x 3700		
				2150 x 1800		2750 x 2650	2750 x 4850 x 3700		
1800	24	4	240	2100 x 1750	1100 x 2100	2700 x 2600	2700 x 4800 x 3700	HK+2700	3500
				2150 x 1800		2750 x 2650	2750 x 4850 x 3700		
				2100 x 1750	1200 x 2100	2700 x 2600	2700 x 4800 x 3700		
				2150 x 1800		2750 x 2650	2750 x 4850 x 3700		
1800	24	5	240	2100 x 1750	1100 x 2100	2700 x 2600	2700 x 4800 x 4000	HK+2800	3500
				2150 x 1800		2750 x 2650	2750 x 4850 x 4000		
				2100 x 1750	1200 x 2100	2700 x 2600	2700 x 4800 x 4000		
				2150 x 1800		2750 x 2650	2750 x 4850 x 4000		

Reaction load				Motor	Power supply capacity (380 V – 415 V)								Starting power	Heat dissipation in machine room	
R1 kg	R2 kg	R3 kg	R4 kg	PME KW	1 Unit kVA	2 Unit kVA	3 Unit kVA	4 Unit kVA	5 Unit kVA	6 Unit kVA	7 Unit kVA	8 Unit kVA	kVA	KW	Kcal/h
15400	9700	19100	8600	34.8	48.6	88.4	131.1	170.9	204.0	233.1	261.8	291.4	105	2.44	2071
15500	9700	19100	8700												
15400	9700	19100	8600												
15600	9700	19100	8700												
18800	12000	21400	9000	42.9	60.9	110.8	164.4	214.4	255.8	292.3	328.2	365.4	139	3.00	2553
19000	12100	21400	9100												
18800	12000	21400	9000												
19000	12100	21400	9100												
31800	19900	20900	8600	52.7	75.4	137.3	203.7	265.6	316.9	362.1	406.7	452.7	162	3.69	3136
32100	20000	21000	8700												
31800	19900	20900	8700												
32100	20000	21000	8700												
31800	19900	20900	8600	63.2	88.1	160.3	237.7	310.0	369.8	422.7	474.6	528.3	189	4.42	3761
32100	20000	21000	8700												
31800	19900	20900	8700												
32100	20000	21000	8700												
13900	8800	13300	8700	26.4	40.6	73.9	109.6	142.9	170.5	194.9	218.8	243.6	78	3.96	3366
14000	8800	13400	8800												
13900	8800	13300	8700												
14100	8800	13400	8800												
15500	9600	15600	9100	28.0	42.7	77.8	115.4	150.5	179.5	205.2	230.4	256.5	84	4.20	3570
15600	9600	15700	9200												
15500	9600	15600	9200												
15600	9700	15700	9200												
19200	12100	17900	9600	34.8	51.0	92.8	137.7	179.5	214.2	244.8	274.8	305.9	106	2.44	2071
19300	12100	18000	9600												
19200	12100	17900	9600												
19300	12100	18000	9700												
19100	12200	19900	9600	41.1	58.7	106.9	158.6	206.8	246.7	282.0	316.7	352.5	127	2.88	2446
19300	12300	19900	9700												
19100	12300	19900	9600												
19300	12300	19900	9700												
19600	12500	21800	9600	47.6	66.6	121.3	179.9	234.6	279.9	319.9	359.2	399.9	148	3.33	2833
19800	12600	21800	9700												
19600	12600	21800	9600												
19800	12600	21800	9700												
35100	21800	21300	9300	54.0	75.9	138.1	204.8	267.0	318.6	364.1	408.9	455.2	165	3.78	3213
35400	21900	21400	9300												
35200	21800	21300	9300												
35500	21900	21400	9400												

Planning parameters.

Load		Speed	Travel height max.	Car	Door	Hoistway	Machine room	Overhead clearance	Pit depth
kg	Persons	m/s	m	BK x TK mm	BT x HT mm	BS x TS mm	BO x TO x HO mm	HSK mm	HSG mm
1800	24	6	240	2100 x 1750	1100 x 2100	2700 x 2600	2700 x 4800 x 4000	HK+3200	3700
				2150 x 1800		2750 x 2650	2750 x 4850 x 4000		
				2100 x 1750	1200 x 2100	2700 x 2600	2700 x 4800 x 4000		
				2150 x 1800		2750 x 2650	2750 x 4850 x 4000		
2000	26	2.5	125	2350 x 1700	1100 x 2100	2950 x 2500	2950 x 4700 x 2500	HK+2400	2200
		2.5	150				2950 x 4700 x 3700		2800
		3	180						HK+2500
		3.5	210			2950 x 2550	2950 x 4750 x 3700	HK+2700	3500
		4	240				2950 x 4750 x 4000	HK+2800	3600
		5							
		6							

Remarks

Overall

- Hoistway width and depth dimensions are based on clear dimensions with horizontal building tolerances of ± 30 mm (for travel height up to 240 m) or ± 25 mm (for travel height up to 80 m)
- Figures with shaded backgrounds are in compliance with EN81-1 1998
- Indicated car sizes are most common. For different sizes, please contact our local sales office
- BK/TK are structural car widths and depths
- HK are structural car heights of 2400 mm – 3200 mm
- The indicated hoistway and machine room sizes are standard sizes without safety gear on counterweight
- The indicated machine room height HO includes a hoisting beam
- Minimal floor distance = HT + 500 mm (based on V50 doors)
- Standard car header distance (HK-HT) is between 200 mm and 1100 mm (based on V50 doors)
- For maximal car and door heights (HK/HT), we recommend the usual application range
- Roping: for speeds from 2.5 m/s – 4 m/s = 2:1, for speeds from 5 m/s to 6 m/s = 1:1
- All given information is for general reference and planning. For special construction and code regulation details, please contact our local sales office

Overhead clearance and pit depth

- For smaller overhead clearance and pit depth, please contact our local sales office

Power supply

- Power supply wiring for lighting: single phase, neutral, earth (to be in accordance with national code requirements)
- Power supply wiring for ACVVVF drive: 3-phase, neutral, earth or 3-phase, earth (to be in accordance with national code requirements)
- Main frequency 50 Hz or 60 Hz

Heat dissipation in hoistway and machine room

- Our equipment is designed to withstand a temperature range of 5 to 40 degrees Celsius
- For the service personnel, the machine room and hoistway temperature should be kept within the range of 5 and 35 degrees Celsius
- The humidity in the machine room should not exceed a monthly average of 90% and a daily average of 98% without condensation

Reaction load				Motor	Power supply capacity (380 V – 415 V)								Starting power	Heat dissipation in machine room	
R1 kg	R2 kg	R3 kg	R4 kg	PME KW	1 Unit kVA	2 Unit kVA	3 Unit kVA	4 Unit kVA	5 Unit kVA	6 Unit kVA	7 Unit kVA	8 Unit kVA	kVA	KW	Kcal/h
35100	21800	21300	9300	64.8	88.8	161.6	239.8	312.6	373.0	426.3	478.7	532.9	194	4.54	3856
35400	21900	21400	9300												
35200	21800	21300	9300												
35400	21900	21400	9400												
14700	9400	13800	9400	29.4	44.8	81.5	120.8	157.5	188.0	214.8	241.2	268.5	85	4.41	3749
18600	11900	16100	9600	31.1	48.0	87.4	129.6	169.0	201.6	230.5	258.8	288.1	93	4.67	3966
19700	12500	18200	10000	38.3	55.4	100.9	149.6	195.1	232.8	266.0	298.7	332.5	113	2.68	2279
20200	13000	20200	10000	45.3	63.9	116.3	172.5	224.8	268.3	306.6	344.3	383.3	134	3.17	2696
20100	13000	22100	10100	52.4	72.4	131.8	195.5	254.8	304.1	347.5	390.2	434.4	157	3.67	3118
39000	24500	22300	10000	64.3	89.7	163.3	242.2	315.8	376.8	430.6	483.6	538.3	192	4.50	3826
39000	24500	22300	10000	77.2	105.0	191.0	283.4	369.5	440.8	503.8	565.7	629.8	225	5.40	4594



Hoistway and machine room sample layout

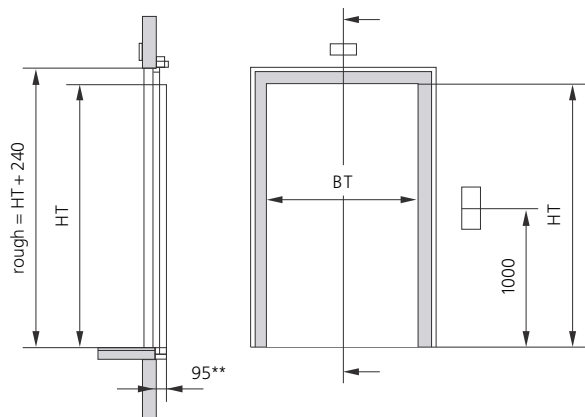
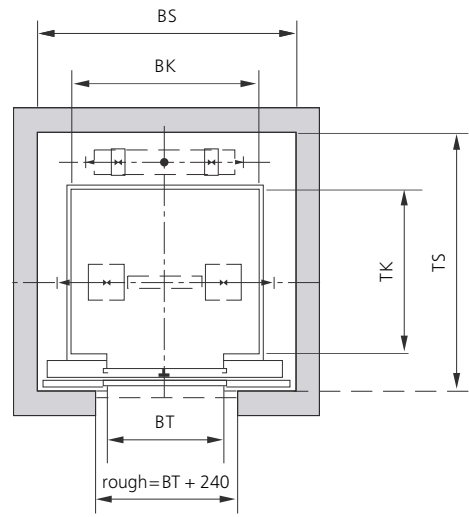
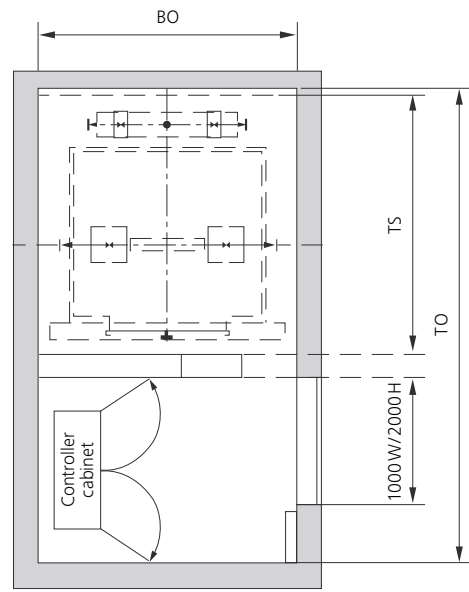
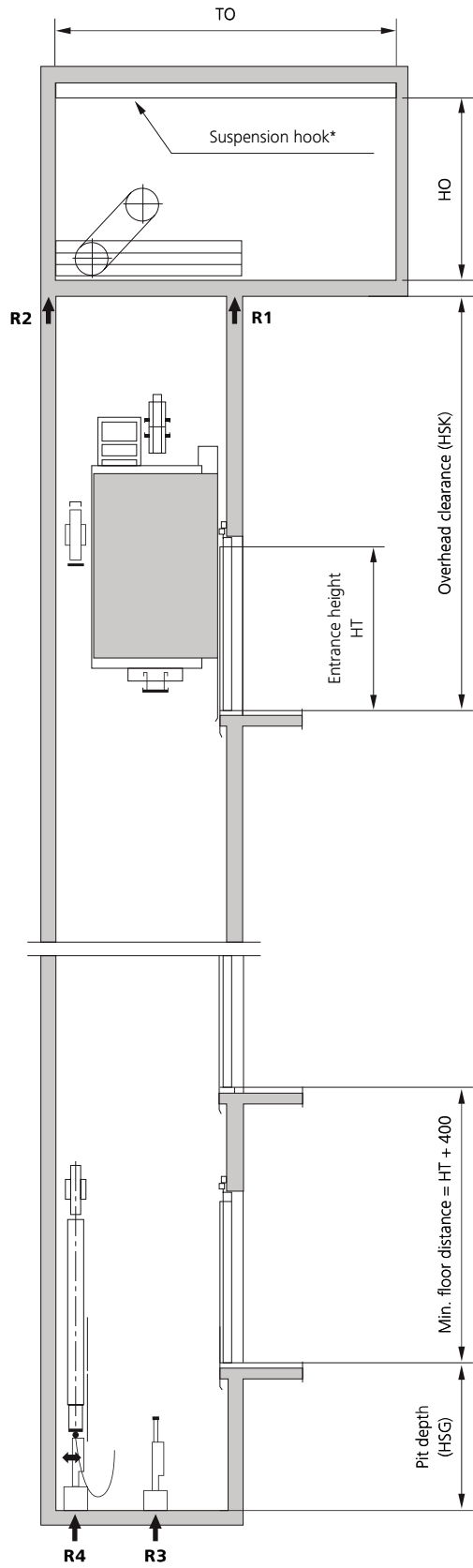

Disclaimer

The specifications, options and colors expressed within this brochure are indicative only and are subject to change without notice. They are not intended to, and do not, constitute an offer on the part of the Schindler Group.

HT= Entrance height

* By building contractors

** 95 mm for pocket sill support & 100 mm min. for pocketless sill support

A partnership
which takes you to the top.

Schindler Elevator Ltd.
Top Range Division

Zugerstrasse 13
6030 Ebikon, Switzerland
Phone +41 41 445 31 31
Fax +41 41 445 36 69

trc@ch.schindler.com
www.schindler.com